

HILLTOP HOUSE FLOOR PLAN GROUND LEVEL

Plan is not drawn to scale

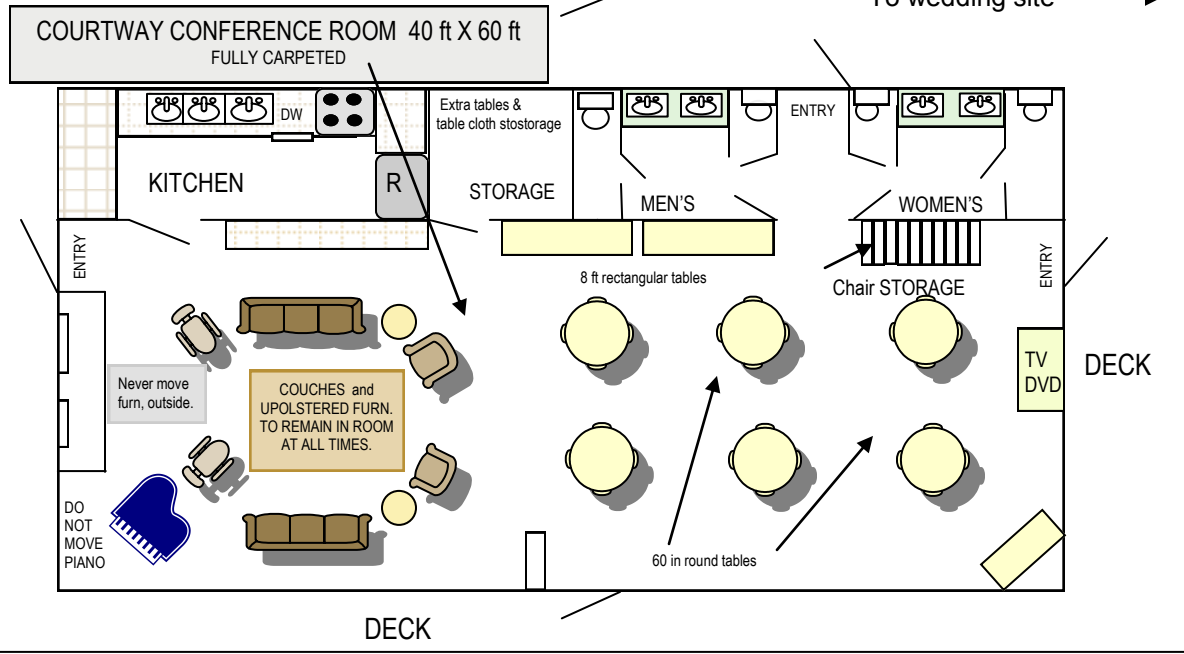

- CHAIRS/TABLES**
Hilltop House:
- 24 – 60" diameter round conference tables
 - 5 - rectangle tables 8' long
 - 3 -rectangle tables 6' long
 - 1 - rectangle table 4' long
 - 40 Bistro tables – 28" square
- * Conference Rounds can seat varying numbers of guests. We have seen 7-10 people at these tables.
 - * There are 7 – 10 picnic tables scattered on the grounds of the Hilltop House
 - * There are 125 bistro chairs

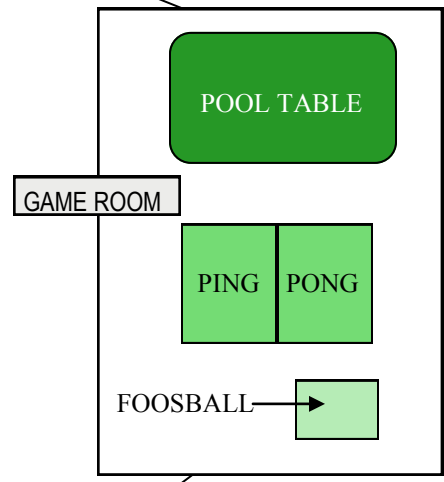
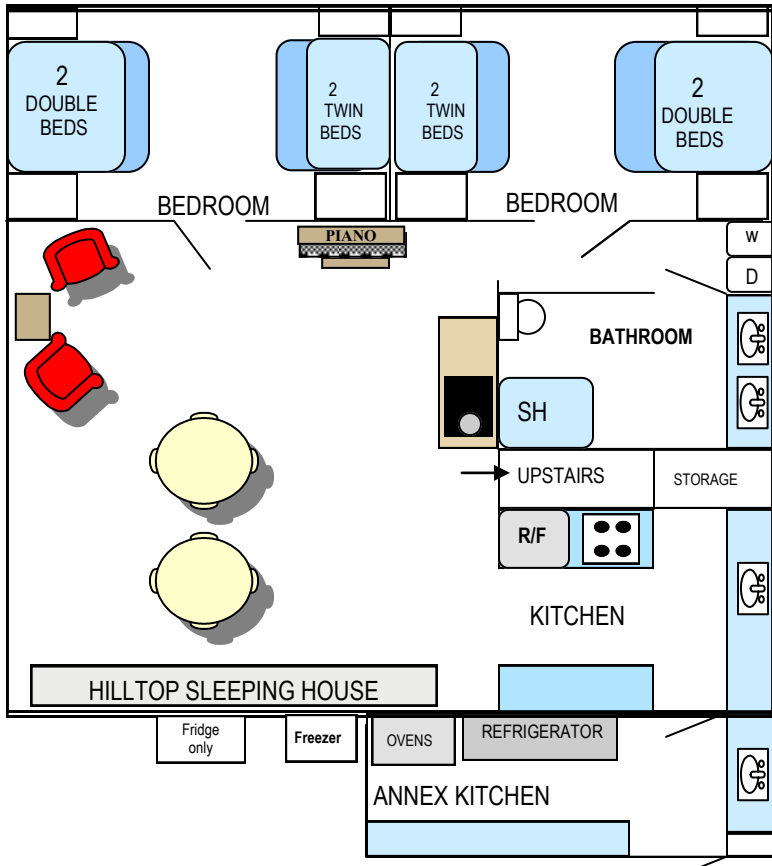

HILLTOP HOUSE FLOOR PLAN

UPPER LEVEL & CABINS

Plan is not drawn to scale

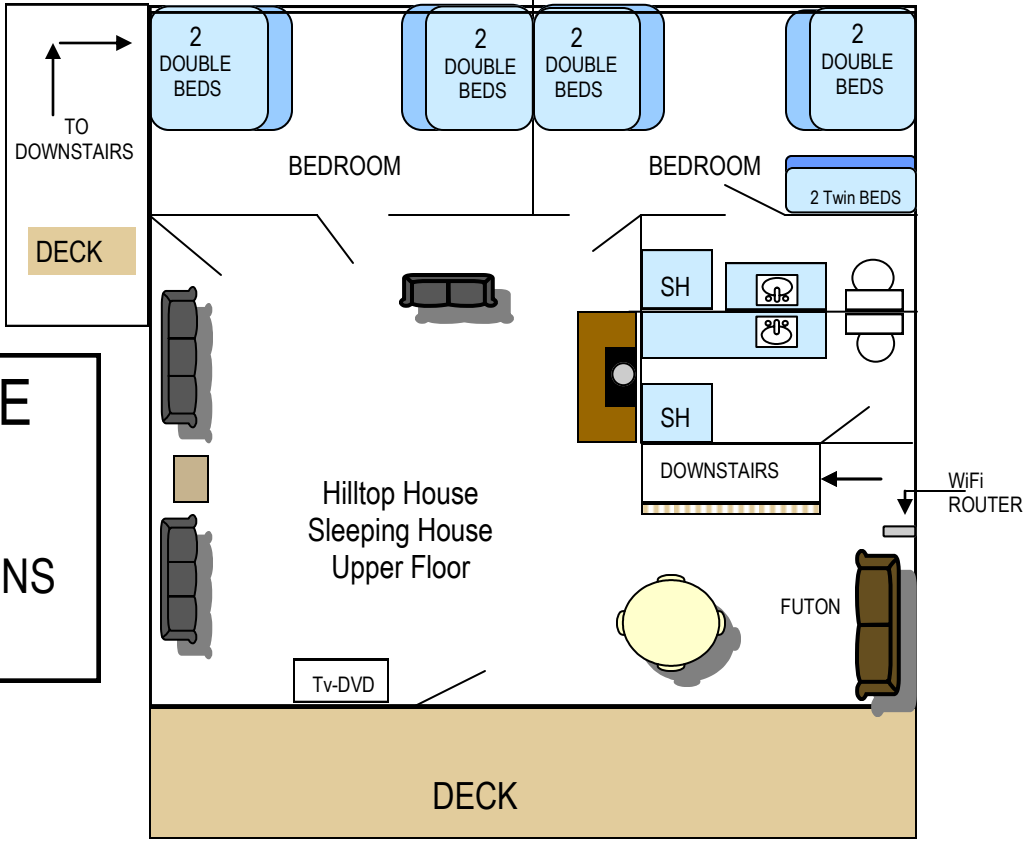

3 CABINS
Maximum 4 people each

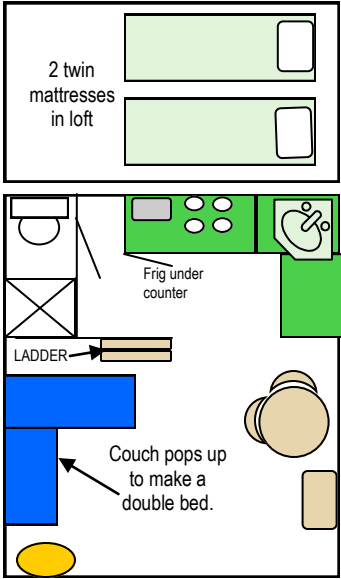

SMÅLAND CABIN

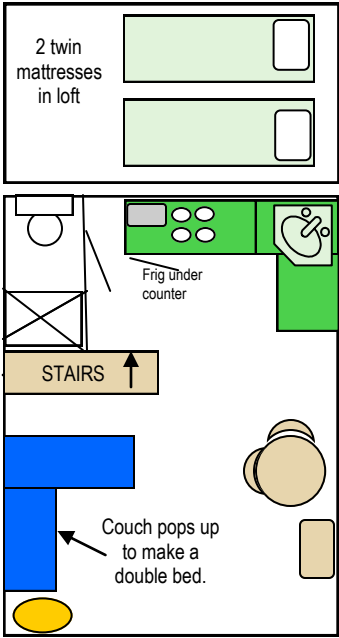

HÄLSINGLAND CABIN

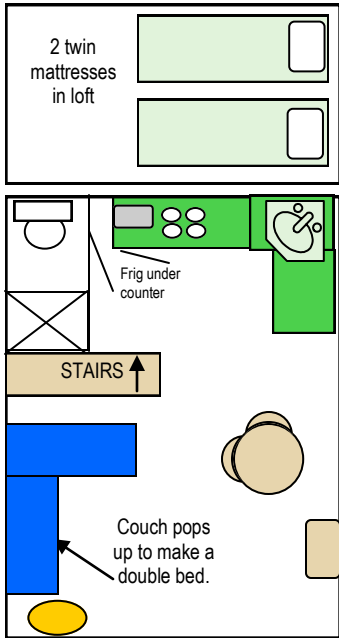

JÄMTLAND CABIN